

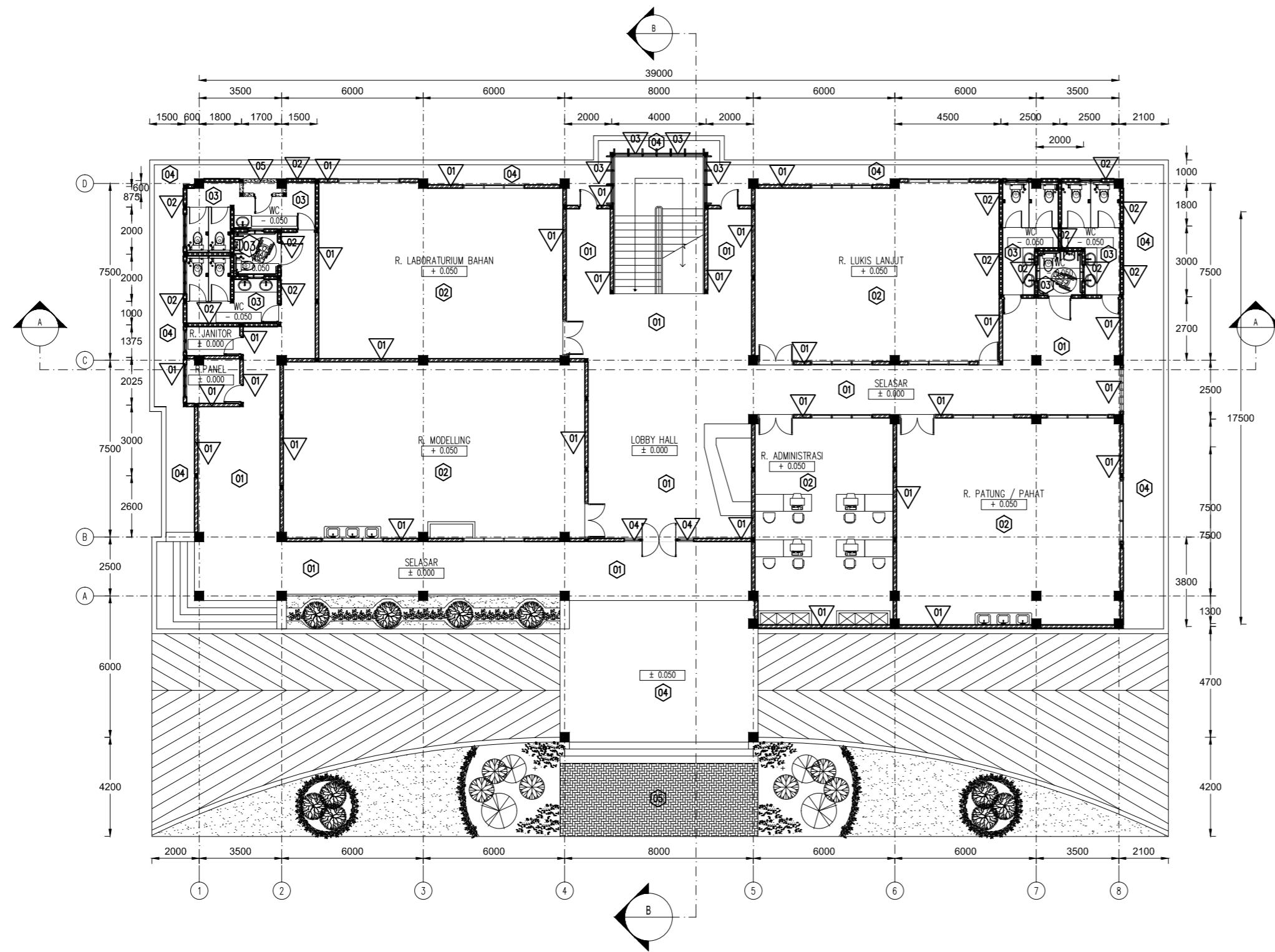

| DIPERIKSA OLEH | | |
|----------------------------|-----------------------|-----|
| NAMA DOSEN | NIP DOSEN | TTD |
| Ir. Hermin Werdingsih, MTA | 19601021 199003 2 002 | |
| Rizsa Riskiyanto, ST, MT. | 19840827 201212 1 003 | |

| | |
|------------------------------|-----------------------|
| Ir. Bambang Adj Martono, MSA | 19530505 198503 1 001 |
| Ir. Hermin Werdingsih, MTA | 19601021 199003 2 002 |

| REV. | DISETUJUI | REVISI | TGL. |
|------|-----------|--------|------|
| | | | |
| | | | |
| | | | |
| | | | |
| | | | |
| | | | |
| | | | |
| | | | |
| | | | |
| | | | |



LEGENDA :

DINDING

- 01 Dinding Pas.1/2 Batu Bata + Plesteran+Aci+Fin.Cat Dulux Mocca
- 02 Dinding Pas.1/2 Batu Bata + Trasram+Aci+Fin.Cat Putih Waterproof
- 03 Dinding Kaca 12mm+Spider
- 04 Dinding Kaca 8mm+Rangka Frame Aluminium
- 05 Dinding Beton

LANTAI

- 01 Lantai Granit Tile White 60x60cm
- 02 Lantai Granit Tile Mocca 40x40cm
- 03 Lantai Keramik Non Slip 20x20cm
- 04 Beton Floor Hardener
- 05 Paving Block

DENAH LANTAI 1
SKALA 1 : 200